

Bergfelde II | House B | Unit 61

Kindergarten - Bergfelde II
Bahnstraße 13, 16562 Hohen Neuendorf



3 rooms | second floor m²

Corridor	13.75
Bathroom 1	7
Bathroom 2	7.07
Kitchen	10.66
Storeroom	3.51
Living room	19.49
Room 1	12.91
Room 2	17.15
Room 3	12.54

Net living area 104.08

Balcony (50%) 4.06

Total living area 108.14

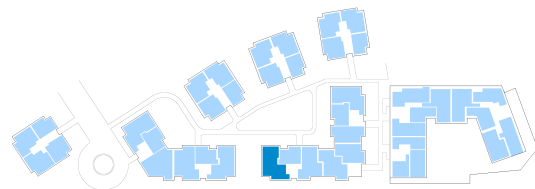

The image and plan material serves the tentative illustration of the project. Deviations in a later planning stage are explicitly reserved. Small variations concerning the areas are possible within a floor plan type. All dimensions are approximate. Due to technical requirements, partial areas can possibly be separated, and ceilings can be suspended.

The terraces and balconies are counted towards 50%.