

Ahornhöfe - Scheunen & Remisen | barn 2 | house B

Living in the Ahornhöfe
 Ahornweg 16 B, 14547 Beelitz-Heilstätten

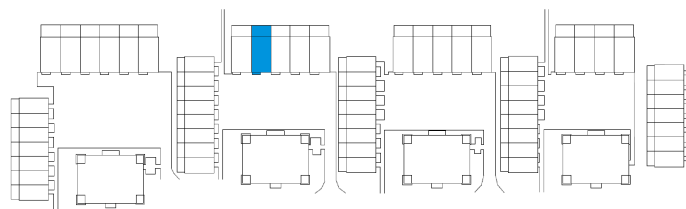

4 rooms	m ²
Hall	7.86
Corridor	6.66
Bathroom 1	4.11
Bathroom 2	9.17
Eat-in kitchen	41.77
Storeroom	4.49
Room 1	13.54
Room 2	17.41
Room 3	15.67
Room 4	12.89
Net living area	133.57
Terrace (50%)	13.36
Total living area	146.93



The image and plan material serves the tentative illustration of the project. Deviations in a later planning stage are explicitly reserved. Small variations concerning the areas are possible within a floor plan type. All dimensions are approximate. Due to technical requirements, partial areas can possibly be separated, and ceilings can be suspended.

The terraces and balconies are counted towards 50%.