

# Beelitz-Waldresidenz | Unit 135

Living in a historical monument

Dr. Herrmann-Straße 4g, 14547 Beelitz-Heilstätten

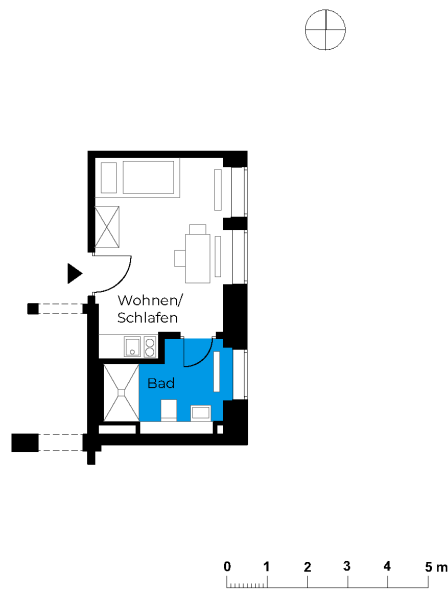

1 room   first floor	m <sup>2</sup>
Bathroom	5.86
Living room	14.96
<b>Net living area</b>	<b>20.82</b>
<b>Total living area</b>	<b>20.82</b>

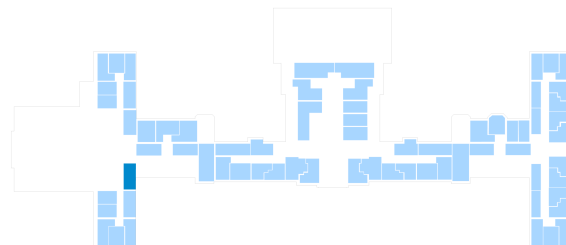

The image and plan material serves the tentative illustration of the project. Deviations in a later planning stage are explicitly reserved. Small variations concerning the areas are possible within a floor plan type. All dimensions are approximate. Due to technical requirements, partial areas can possibly be separated, and ceilings can be suspended.

The terraces and balconies are counted towards 50%.