

# Beelitz-Waldresidenz | Unit 88

Living in a historical monument

Dr. Herrmann-Straße 4, 14547 Beelitz-Heilstätten

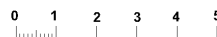
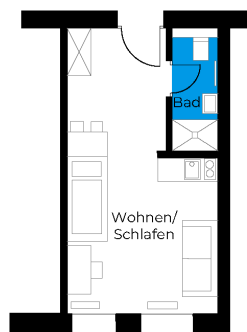

**1 room | attic** **m²**

Bathroom 3.62  
Living room 22.63

Net living area 26.25

**Total living area 26.25**

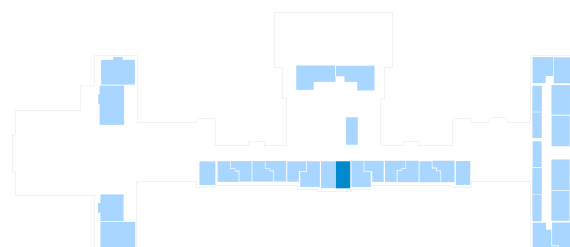

The image and plan material serves the tentative illustration of the project. Deviations in a later planning stage are explicitly reserved. Small variations concerning the areas are possible within a floor plan type. All dimensions are approximate. Due to technical requirements, partial areas can possibly be separated, and ceilings can be suspended.

The terraces and balconies are counted towards 50%.