

# Beelitz-Waldresidenz | Unit 58

Living in a historical monument

Dr. Herrmann-Straße 4c , 14547 Beelitz-Heilstätten

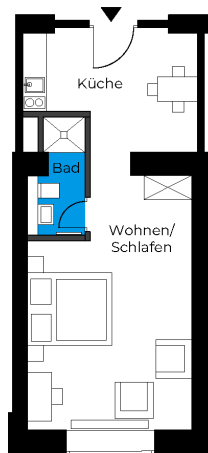

1 room   first floor	m <sup>2</sup>
Bathroom	3.6
Kitchen	12.25
Living room	23.46
<u>Net living area</u>	<u>39.31</u>
 <b><u>Total living area</u></b>	 <b><u>39.31</u></b>

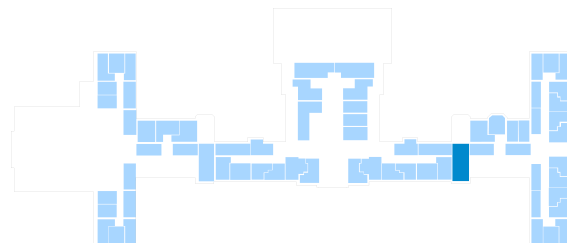

The image and plan material serves the tentative illustration of the project. Deviations in a later planning stage are explicitly reserved. Small variations concerning the areas are possible within a floor plan type. All dimensions are approximate. Due to technical requirements, partial areas can possibly be separated, and ceilings can be suspended.

The terraces and balconies are counted towards 50%.